



SEALING PLUGS

SERIES LK 950

KOENIG-EXPANDER®

Material

Sleeve: Case Hardening Steel, Soft annealed gun finish
Mandrel: Steel, plain finish, Special oil film lubrication

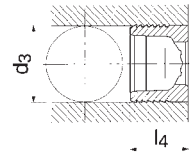
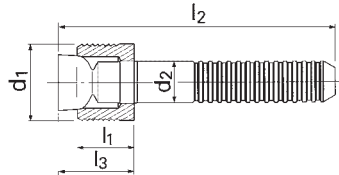

Important: See installation instruction on page 99
Installation requirements on pages 100–106

3D-DATEN: <http://kvt.partcommunity.com>

Part Number	d ₁	l ₁	d ₂	l ₂	d ₃ +0.12 0	l ₃ max.	l ₄ max.	Packaging Unit	
LK 950-040	4,0	3,7	2,2	36	4,0	5,5	4,0	100	1000
LK 950-050	5,0	4,5	2,95	36	5,0	6,9	4,8	100	1000
LK 950-060	6,0	5,0	3,4	36	6,0	7,7	5,3	100	1000
LK 950-070	7,0	5,5	4,2	34	7,0	8,5	5,8	100	500
LK 950-080	8,0	6,5	4,3	34	8,0	9,8	6,8	100	500
LK 950-090	9,0	6,5	4,7	34	9,0	9,8	6,8	100	500
LK 950-100	10,0	6,5	5,1	36	10,0	9,8	6,8	100	500
LK 950-120	12,0	7,5	5,9	36	12,0	11,7	7,8	100	500
LK 950-140	14,0	8,0	5,9	36	14,0	12,2	8,7	100	250
LK 950-160	16,0	10,5	5,9	42	16,0	16,5	11,5	100	250
LK 950-180	18,0	12,0	6,15	46	18,0	18,6	13,0	100	250

Dimensions in millimeters

PRESSURE PERFORMANCE

Series LK 950 mm	Base material of the Installation						
	①	②	③	④	⑤	⑥	⑦
	ETG-100 / 44SMn28 AISI 1144	C15Pb 1.0403	EN-GJL-250 EN 1561	EN-GJS-500-7 EN 1563	AlCu4Mg1 EN AW-2024-T3	AiMgSiPb EN AW-6012-T6	G-AiSi7Mg EN AC-42100
Ø 4 – 18	180 bar / 2.600 psi 60 bar / 850 psi						

Proof Pressure Test ©

Max. allowable Working Pressure = Nominal Pressure